

# Rollgum Fix

SELF-ADHESIVE EPDM  
waterproofing membrane

## Technical Installation Guide on WOODEN SHEDS



**Rollgum**

Waterproofing systems  
with EPDM membranes

# Rollgum Fix

SELF-ADHESIVE EPDM waterproofing membrane

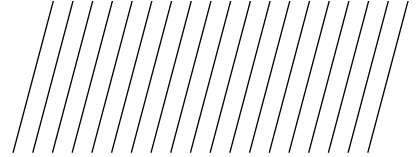

## Technical installation guide on WOODEN SHEDS

### Description

Rollgum Fix is a self-adhesive waterproofing membrane. The outer layer is made of vulcanized EPDM rubber in black color, suitable for exposure to weather, with 400% elasticity and high impact resistance. The inner layer is fully adhesive due to the addition of a water-based dispersion adhesive, free of solvents and VOCs. This layer is protected by a white release film.



### Preparation

Make sure all the components of the roof are assembled and adjusted. The structure must be fully stabilized before climbing onto the roof. Follow your country's safety measures for working at heights.

Carefully inspect the roof surface before installing the Rollgum Fix waterproofing membrane and check:

- The support must be dry, free of dust and clean.
- There are no sharp elements, such as splinters, nail heads or protruding screws.
- There are no cutting or aggressive edges or joints between boards.

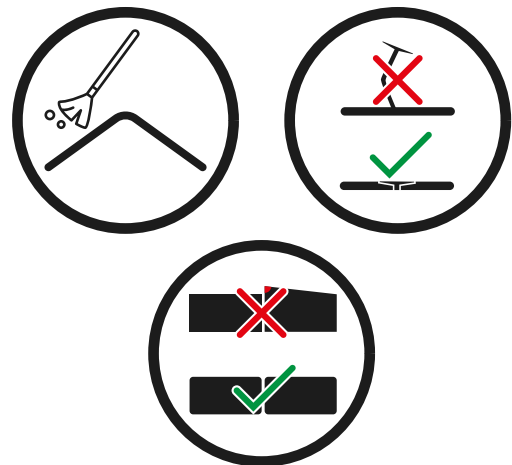

### Necessary tools

1. White Marker.
2. Scissors (don't use cutter or knives).
3. Pressure roller.

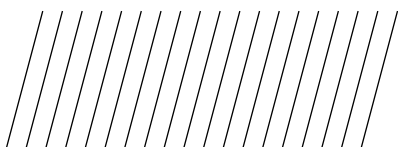
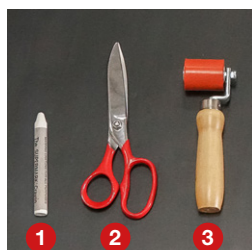

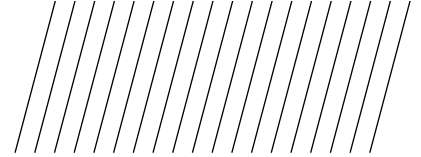

## Technical installation guide on WOODEN SHEDS

### Installation

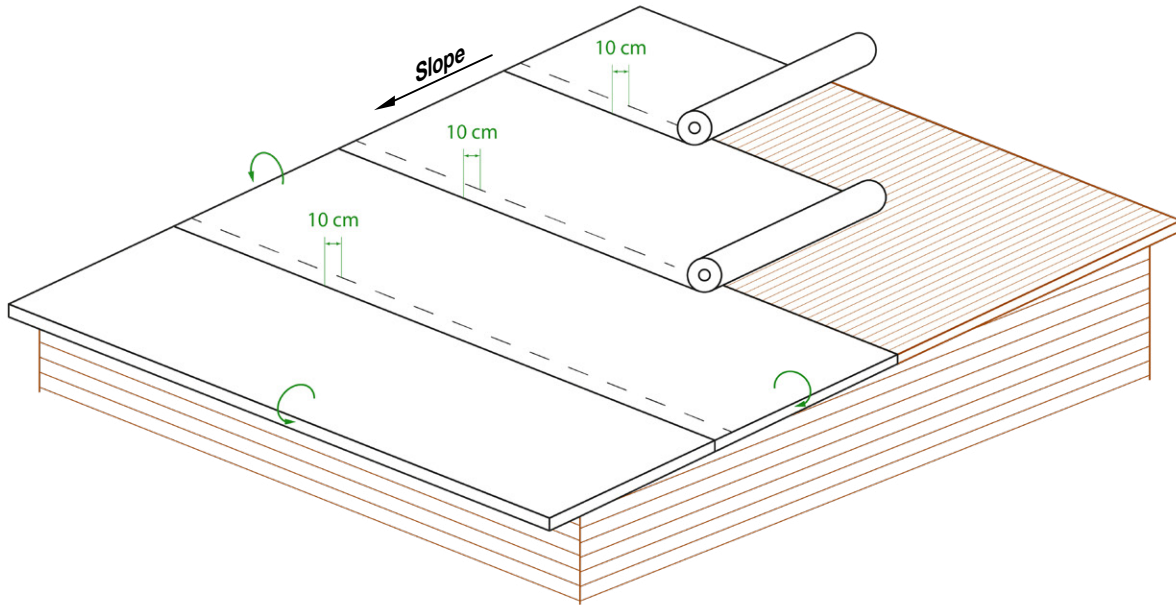

Carry out the installation with an ambient temperature above 5°C and below 35°C.

Start at the lowest part of each slope.

Place the membrane on the roof, perpendicular to the direction of the slope. Ensure to reserve enough extra EPDM membrane to cover the perimeter returns according to the type of termination (see details a, b, and c).

It is advisable to let the membranes rest, unrolled, for about 25-30 minutes before installation.

Remove the white protective film without moving the membrane from its final position, pulling the film horizontally. If preferred, each EPDM piece can be adhered in two parts by cutting the protective film in the center of each piece, being careful not to damage the Rollgum Fix membrane, adhering one side first and then the other.

It is recommended to use a brush or broom, sweeping from the center of each piece towards the edges to expel air bubbles and dissipate any wrinkles, and then it is essential to apply pressure with a roller to ensure contact between the membrane and the support over the entire surface.

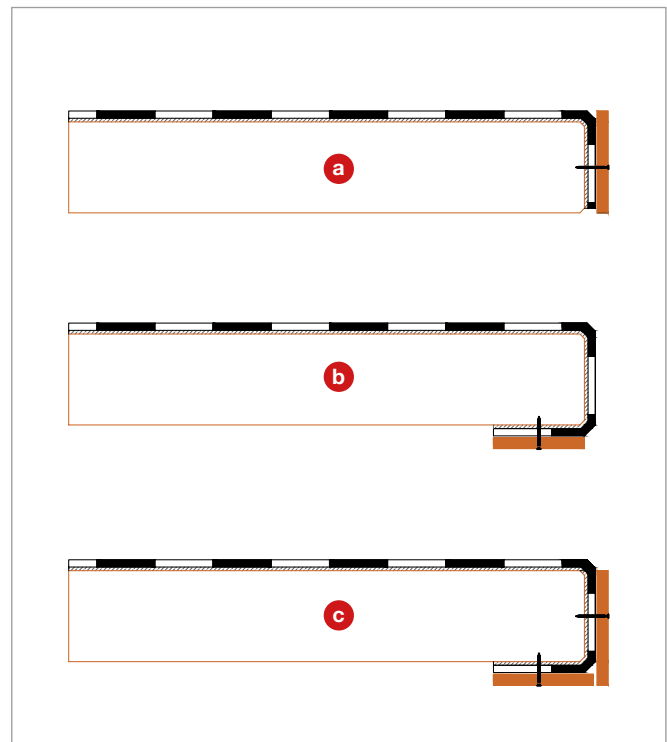

Types of termination

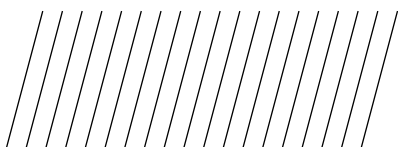

# Rollgum Fix

SELF-ADHESIVE EPDM waterproofing membrane

## Technical installation guide on WOODEN SHEDS

Once pressure is applied, overlap the next Rollgum Fix piece over the previous one, overlapping by a minimum of 10 cm, always in the direction of the slope. Use the system's white marker to indicate the overlap limit and adhere the pieces in parallel.

Do not wait to apply pressure once all Rollgum Fix pieces are in place.

When you reach the ridge or crest, you can use either of the two positions (see details d and e) depending on the dimensions of each roof. The change of slopes should not be sharp or have splinters.

For waterproofing the corners (see details 1 to 4), once the Rollgum Fix EPDM membrane is adhered to the roof, first fold the EPDM on the side edge that goes in the direction of the slope and make a single cut following the right angle of the corner. Then fold the side edge perpendicular to the slope to adhere it to the edge, and fold the excess EPDM flap over the side edge that goes in the direction of the slope. Trim the excess EPDM that extends beyond the edge of the roof with scissors and apply the pressure roller.

Once adhesion is complete, secure the perimeter finishing profiles from your kit.

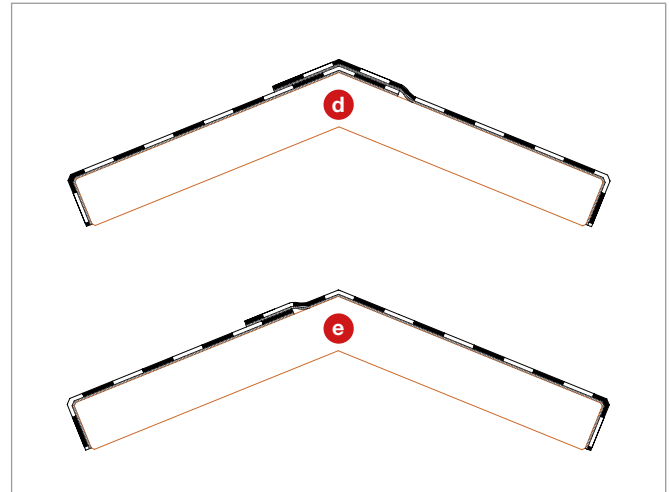

Types of ridge or crest

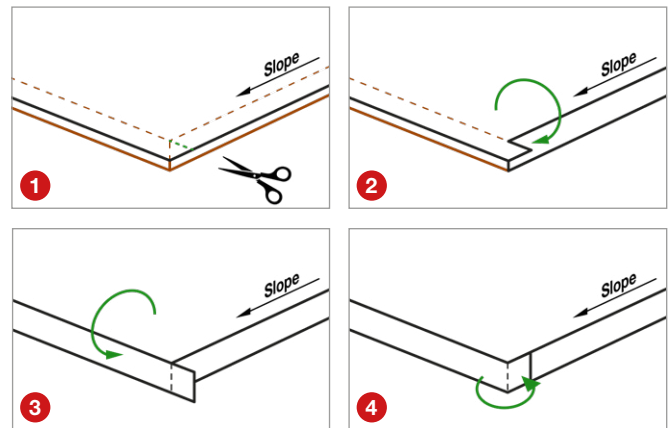

Corner cutting detail

## Storage and Shelf life

- Storage at temperatures of 15 °C to 25 °C and a relative humidity of 40% to 60%.
- Avoid direct sun exposure
- Store away from combustion sources

The EPDM Rollgum Fix membrane does not have an expiration date. The self-adhesive backing should be used within 12 months of its production, provided it is kept in its original sealed packaging and stored properly.

Our information is based on our current knowledge of EPDM technology and its applications. However, we cannot guarantee perfect performance of our products on all surfaces or in all situations due to the variety of substrates and conditions that are beyond our control.

The data and results we provide are derived from our internal tests but do not constitute a legally binding guarantee regarding the specific properties of our products or their suitability for particular uses.

Since our products may have numerous applications, we strongly recommend conducting comprehensive suitability tests on specific materials and conditions of use before implementing them in large-scale projects. For example, we can state that they are suitable for use on wooden surfaces, but it's important to note that there are multiple types of wood with various treatments and surface finish qualities. These factors can influence the results and render our tests non-binding in all situations, even if the surface is made of wood.

Therefore, we do not assume responsibility for any misuse or improper treatment based on the information provided in this document.